

KÖR FLANŞ PN 16



TS EN 1092 - 1 + A1 TİP 5
DIN 2527 PN 16



E.M.P.
www.emp.com.tr
www.empflans.com

BLIND FLANGE PN 16



EN 1092 - 1 + A1 TYPE 5
DIN 2527 PN 16

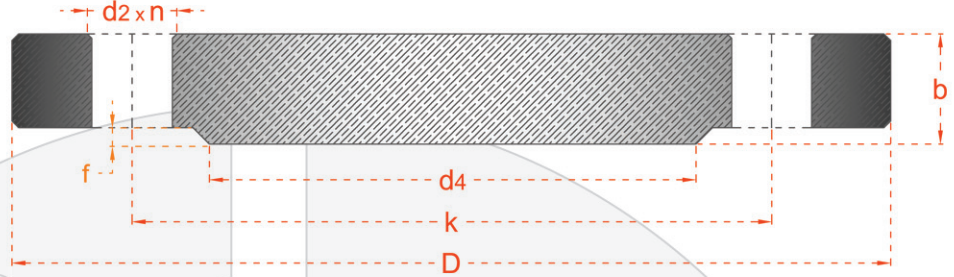

BORU/PİPE	FLANŞ/FLANGE		ALIN/ RAISED FACE		DELİKLER/DRILLINGS				AĞIRLIK WEIGHT	
DN	D	b		d ₄	f	k	n	vida/screw	d ₂	DIN / kg
		EN 1092-1	DIN							
10	90	16	14	40	2	60	4	M12	14	0.5
15	95	16	14	45	2	65	4	M12	14	0.6
20	105	18	16	58	2	75	4	M12	14	0.9
25	115	18	16	68	2	85	4	M12	14	1.1
32	140	18	16	78	2	100	4	M16	18	1.8
40	150	18	16	88	3	110	4	M16	18	2.1
50	165	18	18	102	3	125	4	M16	18	2.9
65	185	18	18	122	3	145	4	M16	18	3.7
80	200	20	20	138	3	160	8	M16	18	4.6
100	220	20	20	158	3	180	8	M16	18	5.6
125	250	22	22	188	3	210	8	M16	18	8.1
150	285	22	22	212	3	240	8	M20	22	10.5
200	340	24	24	268	3	295	12	M20	22	16.2
250	405	26	26	320	3	355	12	M24	26	25.0
300	460	28	28	378	4	410	12	M24	26	35.1
350	520	30	30	438	4	470	16	M24	26	48.0
400	580	32	32	490	4	525	16	M27	30	63.5
450	640	40	34	550	4	585	20	M27	30	82.0
500	715	44	34	610	4	650	20	M30	33	102.5
600	840	54	36	725	5	770	20	M33	36	150.8
700	910	58	36	795	5	840	24	M33	36	176.8
800	1025	62	38	900	5	950	24	M36	39	237.5
900	1125	64	40	1000	5	1050	28	M36	39	301.5
1000	1255	68	42	1115	5	1170	28	M39	42	394.9
1200	1485	müşteri tarafından belirlenecektir	48	1330	5	1390	32	M45	48	630.0
1400	1685		52	1530	5	1590	36	M45	48	883.0
1600	1930		58	1750	5	1820	40	M52	56	1,286.0
1800	2130		62	1950	5	2020	44	M52	56	1,680.0
2000	2345		66	2150	5	2230	48	M56	62	2,161.0

Ölçüler mm olarak verilmiştir.
Çelik ve paslanmaz üretilebilir.

Dimensions are in mm.
Steel and stainless steel can be produce.